

Embranchements 45° HDPE, fiche technique

Embranchements égaux en PE-dur, avec emboîtements et joints

Conformes aux normes : EN 12666 - R 592012 - Qplus 11004 - SKZ-Ü

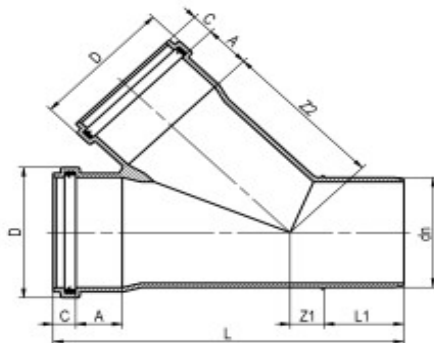

¹ S12,5

* Pièce façonnée

SN2 / SDR33 / S16 - SN4 / S12.5 / SDR26 Couleur noir

dn mm	dn mm	D mm	C mm	A mm	L1 mm	Z1 mm	Z2 mm	L mm	Poids kg	Cart. P.	Pal. P.	Article N°
¹ 110	110	138.4	24.7	83.9	117.5	29.4	152.4	408	1.019	14	56	S16PEEYC110110
¹ 125	125	153.8	24.7	85.0	121.0	30.5	168.8	430	1.578	12	48	S16PEEYC125125
¹ 160	160	199.4	31.0	89.0	134.0	41.7	217.9	515	2.696	5	20	S16PEEYC160160
200	200	231.9	36.7	93.0	143.0	48.0	271.3	592	3.780	4	16	S16PEEY200200
*250	250	293.0	56.0	97.0					13.200			S16PEEY250250
*315	315	363.6	63.0	104.0					23.300			S16PEEY315315
*355	355	406.0	59.0	221.0					24.500			S16PEEY355355
*400	400	433.9	71.0	118.0					32.500			S16PEEY400400

Autres dimensions sur demande

Valeurs indicatives, informatives et non contractuelles.

Embranchements 45° HDPE, fiche technique

Embranchements réduits en PE-dur, avec emboîtements et joints

Conformes aux normes : EN 12666 - R 592012 - Qplus 11004 - SKZ-Ü

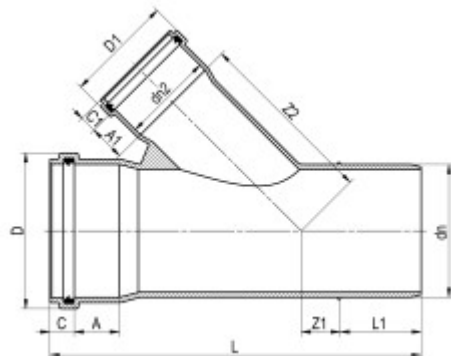

¹ S12,5

* Pièce façonnée

SN2 / SDR33 / S16 - SN4 / S12.5 / SDR26 Couleur noir

dn	dn2	D	C	A	D1	C1	A1	L1	Z1	Z2	L	Poids	Cart.	Pal.	Article
mm	mm	mm	mm	mm	mm	mm	mm	mm	mm	mm	mm	kg	P.	P.	N°
¹ 125	110	153.8	24.7	85.0	138.4	24.7	83.9	121.0	30.5	164.5	430	1.480	12	48	S16PEEYC125110
¹ 160	110	199.4	31.0	89.0	138.4	24.7	83.9	134.0	41.7	201.3	515	2.454	6	24	S16PEEYC160110
¹ 160	125	199.4	31.0	89.0	153.8	24.7	85.0	134.0	41.7	216.0	515	2.350	6	24	S16PEEYC160125
200	110	231.9	36.7	93.0	138.4	24.7	83.9	143.0	48.0	251.8	592	3.180	4	16	S16PEEY200110
200	125	231.9	36.7	93.0	153.8	24.7	85.0	143.0	48.0	252.3	592	3.210	4	16	S16PEEY200125
200	160	231.9	36.7	93.0	199.4	31.0	89.0	143.0	48.0	275.0	592	3.630	4	16	S16PEEY200160
*250	110	293.0	56.0	97.0	138.4	24.7	83.9					7.900			S16PEEY250110
*250	125	293.0	56.0	97.0	153.8	24.7	85.0					7.900			S16PEEY250125
*250	160	293.0	56.0	97.0	199.4	31.0	89.0					9.600			S16PEEY250160
*250	200	293.0	56.0	97.0	231.9	36.7	93.0					10.300			S16PEEY250200
*315	110	363.6	63.0	104.0	138.4	24.7	83.9					12.000			S16PEEY315110
*315	125	363.6	63.0	104.0	153.8	24.7	85.0					13.200			S16PEEY315125
*315	160	363.6	63.0	104.0	199.4	31.0	89.0					14.100			S16PEEY315160
*315	200	363.6	63.0	104.0	231.9	36.7	93.0					15.400			S16PEEY315200
*315	250	363.6	63.0	104.0	293.0	56.0	97.0					20.200			S16PEEY315250
*355	160	406.0	59.0	221.0	199.4	31.0	89.0					17.800			S16PEEY355160
*355	200	406.0	59.0	221.0	231.9	36.7	93.0					19.300			S16PEEY355200
*400	160	433.9	71.0	118.0	199.4	31.0	89.0					20.800			S16PEEY400160
*400	200	433.9	71.0	118.0	231.9	36.7	93.0					22.300			S16PEEY400200

Autres dimensions sur demande

Valeurs indicatives, informatives et non contractuelles.

Embranchements 90° HDPE, fiche technique

Embranchements en PE-dur, avec emboîtements et joints

Conformes aux normes : EN 12666 - R 592012 - Qplus 11004 - SKZ-Ü

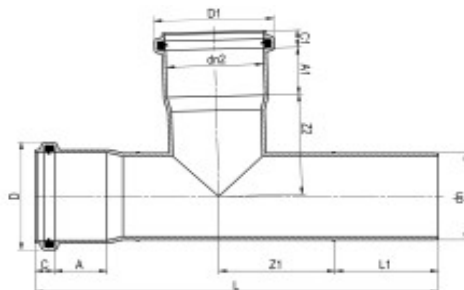

¹ S12,5

* Pièce façonnée

SN2 / SDR33 / S16 - SN4 / S12.5 / SDR26 Couleur noir

dn mm	dn2 mm	D mm	C mm	A mm	D1 mm	C1 mm	A1 mm	L1 mm	Z1 mm	Z2 mm	L mm	Poids kg	Cart. P.	Pal. P.	Article N°
¹ *110	110	138.4	24.7	83.9	138.4	24.7	83.9	117.5				1.400			S16PEET110110
¹ *125	110	153.8	24.7	85.0	138.4	24.7	83.9	121.0				1.800			S16PEET125110
¹ *125	125	153.8	24.7	85.0	153.8	24.7	85.0	121.0				2.000			S16PEET125125
¹ *160	110	199.4	31.0	89.0	138.4	24.7	83.9	134.0				3.100			S16PEET160110
¹ *160	125	199.4	31.0	89.0	153.8	24.7	83.9	134.0				3.200			S16PEET160125
¹ *160	160	199.4	31.0	89.0	199.4	31.0	89.0	134.0				3.600			S16PEET160160
*200	110	231.9	36.7	93.0	138.4	24.7	83.9	143.0				3.900			S16PEET200110
*200	125	231.9	36.7	93.0	153.8	24.7	85.0	143.0				4.000			S16PEET200125
*200	160	231.9	36.7	93.0	199.4	31.0	89.0	143.0				4.500			S16PEET200160
*200	200	231.9	36.7	93.0	231.9	36.7	93.0	143.0				5.100			S16PEET200200
*250	110	293.0	56.0	97.0	138.4	24.7	83.9					8.000			S16PEET250110
*250	125	293.0	56.0	97.0	153.8	24.7	85.0					8.100			S16PEET250125
*250	160	293.0	56.0	97.0	199.4	31.0	89.0					8.700			S16PEET250160
*250	200	293.0	56.0	97.0	231.9	36.7	93.0					9.400			S16PEET250200
*250	250	293.0	56.0	97.0	293.0	56.0	97.0					11.800			S16PEET250250
*315	110	363.6	63.0	104.0	138.4	24.7	83.9					13.500			S16PEET315110
*315	125	363.6	63.0	104.0	153.8	24.7	85.0					13.600			S16PEET315125
*315	160	363.6	63.0	104.0	199.4	31.0	89.0					14.200			S16PEET315160
*315	200	363.6	63.0	104.0	231.9	36.7	93.0					14.300			S16PEET315200
*315	250	363.6	63.0	104.0	293.0	56.0	97.0					16.800			S16PEET315250
*315	315	363.6	63.0	104.0	363.6	63.0	104.0					18.800			S16PEET315315
*355	355	406.0	59.0	221.0	406.0	59.0	221.0					27.200			S16PEET355355
*400	400	433.9	71.0	118.0	433.9	71.0	118.0					37.300			S16PEET400400

Autres dimensions sur demande

Valeurs indicatives, informatives et non contractuelles.